

ELECTRICAL NOTES

1. ALL EXTERIOR RECEPTACLES SHALL BE WEATHERPROOF AND G.F.I.
2. ALL BATHROOM, GARAGE, AND ANY RECEPTACLE WITHIN (6) FEET OF ANY SINK SHALL BE G.F.I. TYPE.
3. ALL EXTERIOR DISCONNECT SWITCHES SHALL BE WEATHERPROOF.
4. ALL LIGHT FIXTURES ARE TO BE SELECTED BY OWNER, SUPPLIED AND INSTALLED BY ELECTRICAL CONTRACTOR.
5. ELECTRICAL CONTRACTOR SHALL COORDINATE METER, METER CENTERS, AND SWITCHGEAR LOCATIONS WITH LOCAL UTILITY COMPANY (F.P. & L.)
6. ALL LIGHTING AND RECEPTACLES SHALL BE INSTALLED IN ACCORDANCE WITH THE NATIONAL ELECTRIC CODE AND ALL LOCAL CODES.
7. RDMEX MAY BE SUBSTITUTED FOR WIRE AND CONDUIT SYSTEM FOR BUILDING INTERIOR ONLY.
8. ALL WHIRLPOOL EQUIPMENT SHALL BE INSTALLED IN ACCORDANCE WITH N.E.C. ARTICLE 690.
9. PROVIDE THE HANDLE FOR DISPOSAL AND DISHWASHER CIRCUIT BREAKERS (ONLY IF ONE RECEPTACLE SUPPLIES BOTH)
10. ALL SWITCHGEAR AND PANELS SHALL BE RATED FOR 75 DEGREES.
11. ELECTRICAL CONTRACTOR SHALL VERIFY ALL HVAC EQUIPMENT LOADS PRIOR TO THE ORDERING OF ANY SWITCHGEAR AND PANELS AND COORDINATE WITH GENERAL CONTRACTOR.
12. ALL SMOKE DETECTORS SHALL BE HARDWIRED TO THE NEAREST BATTERY BACK-UP (NON-CONNECTED) AND INTERFERE WITH ALARM SYSTEM.
13. ALL DISCONNECT SWITCHES AND PANELS SHALL BE INSTALLED IN ACCORDANCE WITH NEC 110-16.
14. INSTALLATION HEIGHTS ABOVE FINISH FLOOR TO CENTERLINE U.O.N.:
WALL HUNG TELEPHONE 56" A.F.F.
TELEPHONE JACKS 42" A.F.F.
RECEPTACLES 12" A.F.F.
TELEVISION JACKS 12" A.F.F.
15. RECEPTACLE AND OR JUNCTION BOXES SHALL NOT BE PLACED IN A BRICK TO BRICK CONSTRUCTION.
16. ALL FLOOR MOUNTED RECEPTACLES, TELEPHONE JACKS, ETC. INSTALLATION
17. ALL WIRING TO A/C EQUIPMENT TO BE COPPER.
18. POOL ALARM NOTE: (P.A.) THIS HOUSE WILL BE EQUIPPED WITH A POOL ALARM WITH A SOUND PRESSURE OPERABLE DOORS & WINDOWS WITHIN ACCESS OF POOL AREA

GENERAL NOTES

1. PROVIDE G.F.I. OUTLET AT KITCHEN & BATHROOM COUNTER TOP AREAS, WHERE REQUIRED.
2. PROVIDE SMOKE DETECTORS POWERED BY HOUSE ELECT. WITH BATTERY MONITORED BACKUP. SHALL BE INSTALLED OUTSIDE EACH SLEEPING AREA AND ON EACH FLOOR. THE CEILING POINT OF EACH ADDITIONAL STORY OF THE CONSTRUCTION SHALL BE CONNECTED TO THE OUTLET BY ONE WIRE. WILL CAUSE ALL TO SOUND.
3. PROVIDE RECD CONNECTION FOR GARAGE DOOR OPENERS)
4. PROVIDE RECD. CONNECTIONS FOR ALL KITCHEN APPLIANCES
5. PROVIDE RECD CONNECTIONS FOR MECH. EQUIPMENT.
6. ALL RECESS CANS SHALL BE IC RATED.
7. All bath outlets are to be on at least one separate 20 amp gfi protected circuit.
8. All kitchen counter outlets are to be on at least two separate 20 amp gfi protected circuits.

NOTE: ELECTRICAL CENTER TO BE INSTALLED IN TRUSS RECESS & A/H IN TRUSS RECESS

NOTE: SECURITY LIGHTS TO BE SWITCHED IN ENTRY BEDROOM

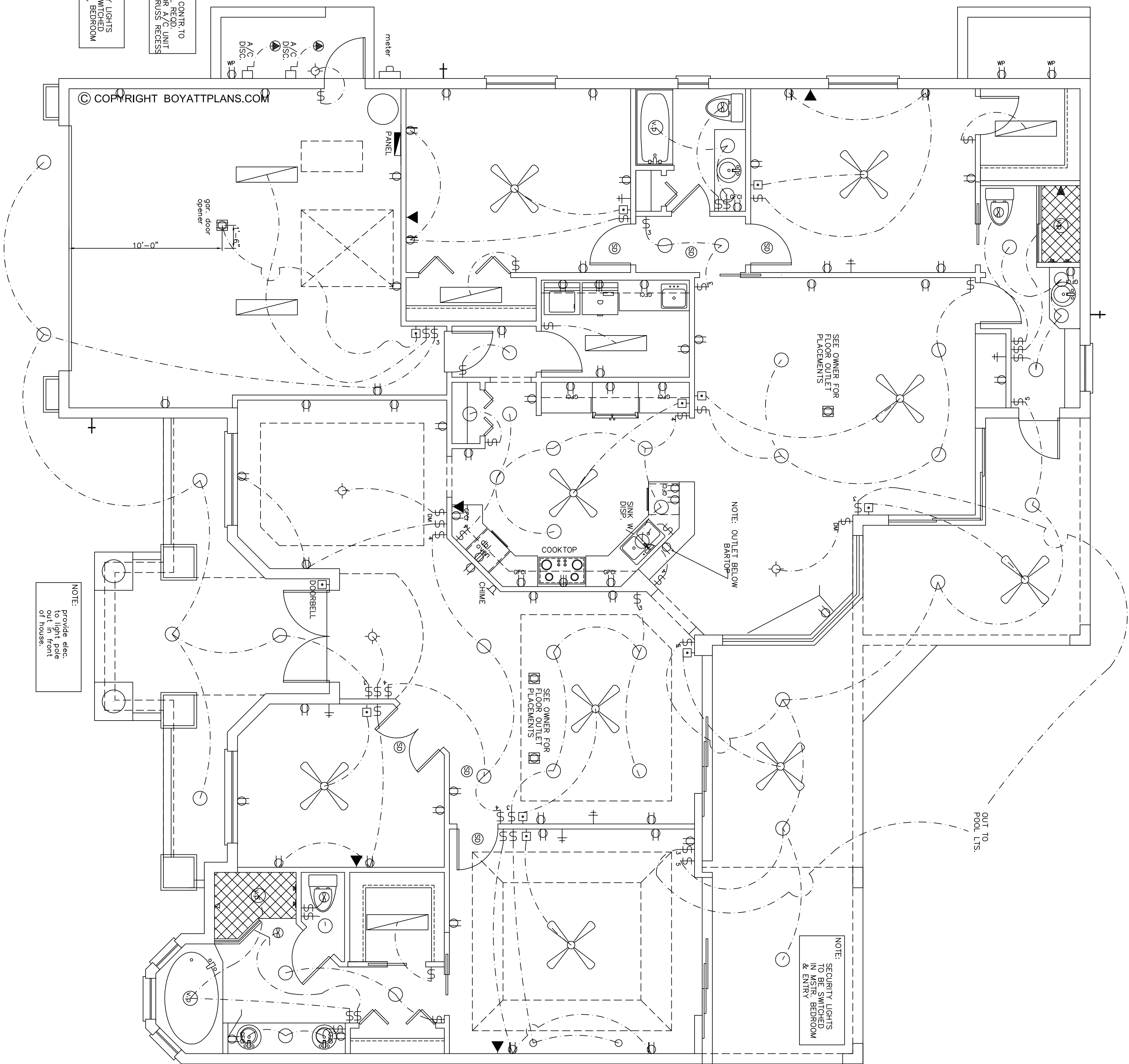

NOTE: provide elec. outlet front of house

NOTE: SECURITY LIGHTS TO BE SWITCHED IN ENTRY BEDROOM

NOTE: OUTLET BELOW BAR TOP

SEE OWNER FOR FLOOR OUTLET PLACEMENTS

SEE OWNER FOR FLOOR OUTLET PLACEMENTS

© COPYRIGHT BOYATTPLANS.COM

COPYRIGHT NOTICE

ALL HOMES SOLD THROUGH BOYATT PLANSON.COM ARE PROTECTED BY COPYRIGHT. NO PART OF THIS DRAWING OR ANY INFORMATION CONTAINED HEREIN IS TO BE REPRODUCED, COPIED, OR TRANSMITTED IN ANY FORM OR BY ANY MEANS, WITHOUT THE WRITTEN PERMISSION OF BOYATTPLANS.COM. THIS NOTICE IS SET TO THE PLAN AS EXCEPT FOR A LIMITED LICENSE TO USE THE SET FOR HOME PLANS FOR THE CONSTRUCTION OF A SINGLE DWELLING UNIT. ANY OTHER USE OF THIS SET OF HOME PLANS WITHOUT THE WRITTEN PERMISSION OF BOYATTPLANS.COM IS PROHIBITED. BOYATTPLANS.COM DOES NOT CONVEY TO THE BUYER A LICENSE TO CONSTRUCT MORE THAN ONE DWELLING UNIT. SIMILARLY, THE PURCHASE OF REPRODUCIBLE HOME PLANS WILL NOT CONVEY TO THE BUYER A LICENSE TO MAKE OR REPRODUCE ANY OTHER SET OF HOME PLANS. BOYATTPLANS.COM WILL MAKE UP TO A MAXIMUM OF 10 COPIES FOR THE CONSTRUCTION OF A SINGLE DWELLING UNIT. IT IS NECESSARY TO CONTACT THE PLAN DESIGNER TO RECEIVE RELEASE AND LICENSE FOR ANY EXTENDED USAGE. WHEREAS A PURCHASER OF REPRODUCIBLE HOME PLANS IS GRANTED A LICENSE TO MAKE COPIES, THE PURCHASER OF REPRODUCIBLE HOME PLANS IS NOT GRANTED THE RIGHT TO MAKE COPIES, REPRODUCE, OR TRANSMIT IN ANY FORM OR BY ANY MEANS, WITHOUT THE WRITTEN PERMISSION OF BOYATTPLANS.COM. THE BUYER'S OBLIGATION IS TO OBTAIN THE NECESSARY PERMITS AND LICENSING OF HOME PLANS FOR CONSTRUCTION EXISTING TO PROTECT ALL PARTIES. BOYATTPLANS.COM HAS BEEN RETAINED TO OVER THE PLAN DESIGNER, WITH ALL INFORMATION CONCERNING THE PLAN DESIGNER, TO BE SET AND LIT IN THE PLAN DESIGNER'S ATTORNEY'S FEES, DAMAGES AND LOSS OF PROFITS. SPECIAL NOTE: COPYRIGHT LICENSE RELEASE FORM IS NONTRANSFERABLE FROM ITS ORIGINAL ISSUANCE PARTY.

THESE PLANS MUST BE THOROUGHLY REVIEWED BY A LICENSED ARCHITECT, PROFESSIONAL ENGINEER, GENERAL CONTRACTOR LICENSED TO PRACTICE IN THE GEOGRAPHICAL AREA IN WHICH THESE PLANS WILL BE USED.

THESE PLANS ARE TO BE CONSIDERED AS CONCEPTUAL ONLY AND NOT BE CONSIDERED AS A FINAL SET OF ENGINEERED DOCUMENTS FOR CONSTRUCTION PURPOSES. IT SHALL BE THE RESPONSIBILITY OF THE PURCHASER/OWNER, ARCHITECT, ENGINEER, CERTIFIED DESIGNER, AND/OR GENERAL CONTRACTOR, LICENSED TO PRACTICE IN THAT PARTICULAR GEOGRAPHICAL AREA, IN WHICH THESE PLANS ARE TO BE USED, TO OBTAIN ALL NECESSARY INFORMATION OR ADDITIONAL LIBRARY/SITE, STRUCTURAL, MECHANICAL, ELECTRICAL, ETC.) REQUIRED FOR ACTUAL CONSTRUCTION. BOYATTPLANS.COM SHALL BE RESPONSIBLE FOR THE GENERAL CONCEPTS AND DETAILS SHOWN. BOYATTPLANS.COM SHALL NOT BE RESPONSIBLE FOR THE MATERIAL COMPOSITION AND DETAILING OF MATERIALS SPECIFIED IN THESE PLANS. BOYATTPLANS.COM SHALL BE RESPONSIBLE FOR THE GENERAL CONCEPTS AND DETAILS SHOWN. BOYATTPLANS.COM SHALL BE RESPONSIBLE FOR THE GENERAL CONCEPTS AND DETAILS SHOWN.

ELECTRICAL SYMBOL LEGEND

SYMBOL	DESCRIPTION
	ELECTRICAL PANEL SURFACE MOUNT
	220 VOLT OUTLET
	1/2 SWITCHED DUPLEX OUTLET
	DUPLEX OUTLET
	DUPLEX OUTLET WEATHERPROOF
	DUPLEX OUTLET FLOOR MOUNT - CEILING INTERRUPT
	DUPLEX OUTLET COVERED FLOOR MOUNT - CEILING MOUNT
	DUPLEX OUTLET
	SILENT SWITCH 3 WAY
	SILENT SWITCH 4 WAY
	SILENT SWITCH 5 WAY
	DIMMER SWITCH
	TELEPHONE OUTLET
	CABLE / SATELLITE TELEVISION OUTLET
	DOORBELL / FAN CONTROL / SENSOR / GENERAL CONTROLS
	HANGING LIGHT FIXTURE
	RECESSED LIGHT FIXTURE
	FLOOD LIGHTS
	HOLLYWOOD LIGHT STRIP
	FLUORESCENT LIGHT STRIP
	RECESSED EXHAUST FAN WITH LIGHT
	SMOKE DETECTOR
	EQUIPMENT CONNECTION
	DISCONNECT SWITCH
	ELECTRICAL METER
	FLUORESCENT LIGHT FIXTURE
	CEILING FAN OUTLET LOCATION SEE CONTRACTOR FOR FAN LOCATIONS

ELECTRICAL PLAN
SCALE: 1/4" = 1'-0"

ANY REPRODUCTION OF THESE PRINTS IS PROHIBITED BY FEDERAL COPYRIGHT LAWS. ANY ILLEGAL REPRODUCTION WILL BE AGGRESSIVELY PURSUED TO THE FULLEST EXTENT OF THE COPYRIGHT LAW.
© THE BOYATT GALLERY OF HOMES

DESIGNER DISCLAIMER: BOYATTPLANS.COM has put substantial care and effort into this home design and the completion of these construction drawings. However, BOYATTPLANS.COM have not been contracted to provide personal consultation, site visitation or field inspection services and have no control over the construction materials, methods or sequencing by the builder. For these reasons, as well as the gross variations in local building codes, Boyatt Gallery of Homes assumes no responsibility for any damages, including structural failures resulting from errors or omissions in these construction drawings. We strongly recommend that you, the homeowner, have these drawings thoroughly reviewed by a licensed architect, professional engineer, certified residential designer or general contractor licensed to practice in your area, in addition to your local building officials, prior to beginning construction.

DATE:	2004
PROJECT #:	BGH-1001-2
DRAWN BY:	bgh
CHECKED BY:	
REVISIONS:	
SHEET #:	1

BOYATTPLANS.COM, BOYATT DESIGN GROUP, INC. IS NOT RESPONSIBLE FOR THE CONSTRUCTION OF THESE PLANS. BOYATTPLANS.COM, BOYATT DESIGN GROUP, INC. IS NOT RESPONSIBLE FOR THE CONSTRUCTION OF THESE PLANS. BOYATTPLANS.COM, BOYATT DESIGN GROUP, INC. IS NOT RESPONSIBLE FOR THE CONSTRUCTION OF THESE PLANS. BOYATTPLANS.COM, BOYATT DESIGN GROUP, INC. IS NOT RESPONSIBLE FOR THE CONSTRUCTION OF THESE PLANS.

THE OWNER OR CONTRACTOR FOR THESE PLANS SHALL BE RESPONSIBLE FOR THE CONSTRUCTION OF THESE PLANS. BOYATTPLANS.COM, BOYATT DESIGN GROUP, INC. IS NOT RESPONSIBLE FOR THE CONSTRUCTION OF THESE PLANS. BOYATTPLANS.COM, BOYATT DESIGN GROUP, INC. IS NOT RESPONSIBLE FOR THE CONSTRUCTION OF THESE PLANS.

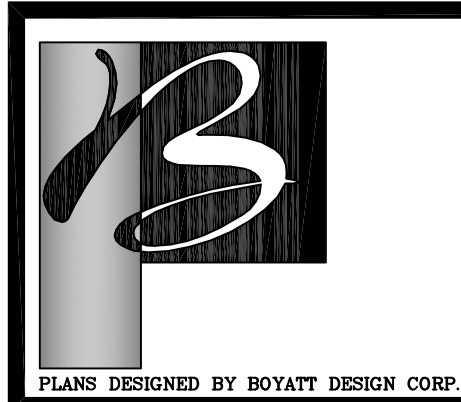

BOYATTPLANS.COM

3387 East 1st Street Suite C
Blue Ridge, Georgia 30513
Ph. 1-866-209-0247

www.boyattplans.com

PLAN NAME:
VILLA DE PALERMO

PLAN NUMBER:
BGH-1001-2